

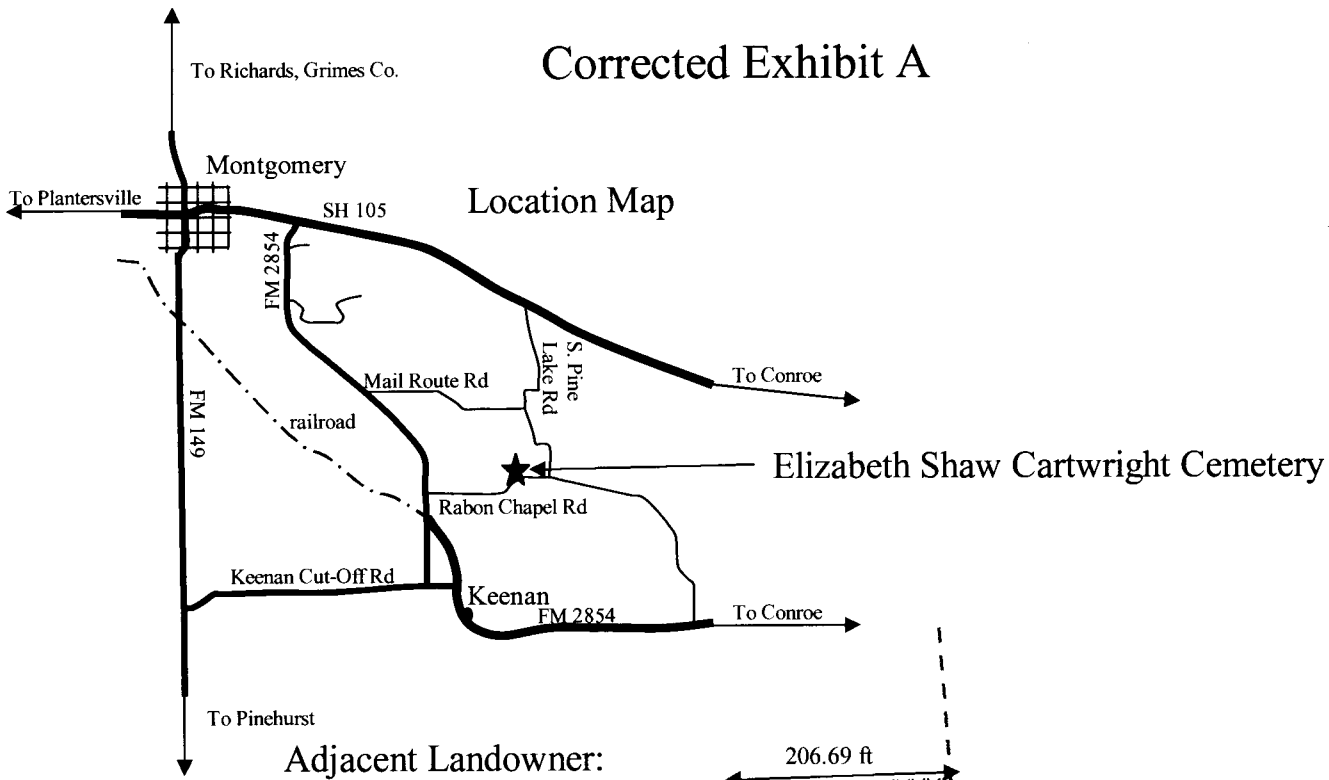

# Corrected Exhibit A



No Scale



Adjacent Landowner:  
Robert & Diane Kendrick

Adjacent Landowner:  
Howard Family  
Revocable Living Trust

Adjacent Landowner:  
Estate of Ida Bell Griffith

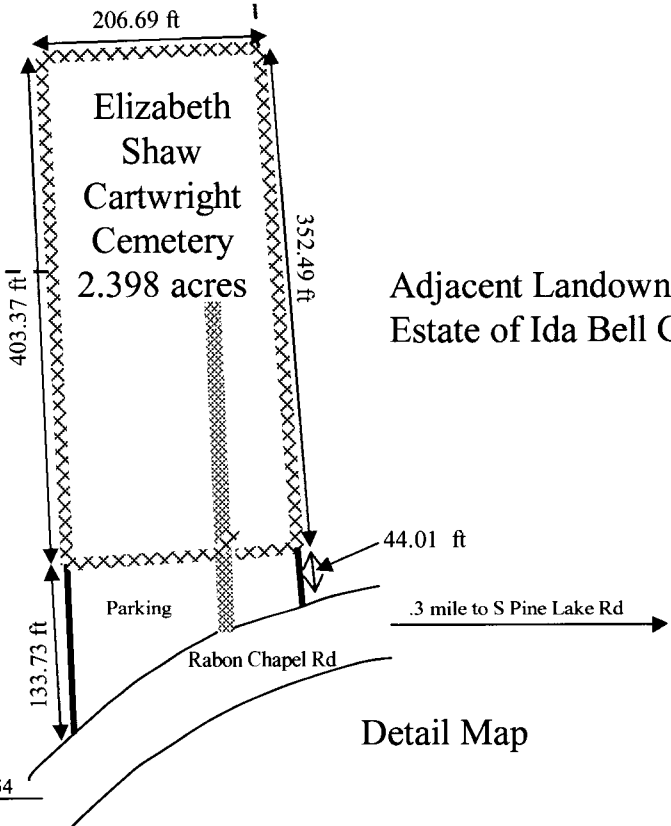

Map adopted from data provided by the applicant, the Montgomery County Appraisal District and Kenneth E. Savoy, R.P.L.S., #5730, November 16, 2009 and October 23, 2009, Conroe, Texas.  
See Deed Records of Montgomery County, Vol. Q, Pg. 5 and Vol. 380-01, Pgs. 157-158  
Located in the William Atkins Survey, A-3, Montgomery County, Texas.  
UTM: Zone: 15 Latitude: 30.3438N Longitude: 95.63536W (NAD83).

## ELIZABETH SHAW CARTWRIGHT CEMETERY

Also known as Cartwright-Sunday Cemetery, Rabon Chapel Cemetery and Rabon-Cartwright Cemetery  
Cemetery No. MQ-C048  
Montgomery County

**FILED FOR RECORD**

11/23/2010 3:30PM

*Mark Jumball*

COUNTY CLERK  
MONTGOMERY COUNTY, TEXAS

STATE OF TEXAS  
COUNTY OF MONTGOMERY

I hereby certify this instrument was filed in file number  
sequence on the date and at the time stamped herein  
by me and was duly RECORDED in the Official Public  
Records of Montgomery County, Texas.

11/23/2010



*Mark Jumball*

County Clerk  
Montgomery County, Texas

Ret. To:  
Lady Dalton  
8381 White Oak Loop  
Montgomery TX 77316